

3 of 6: BUTTERFLY

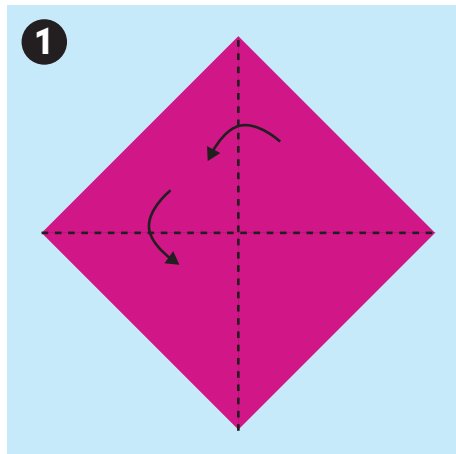

1 Fold your square of paper in half diagonally, and then unfold and fold diagonally the other way. Unfold it again.

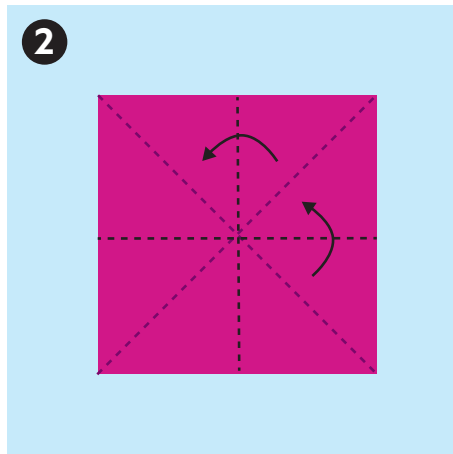

2 Fold the paper in half both ways and then unfold.

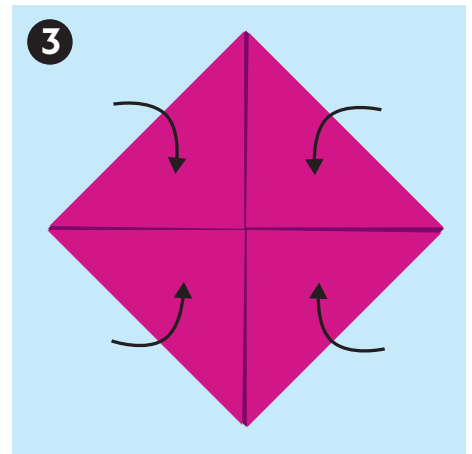

3 Fold all four corners into the centre. Turn the paper over, and fold all corners into the centre again. Unfold so you have a flat square of paper again.

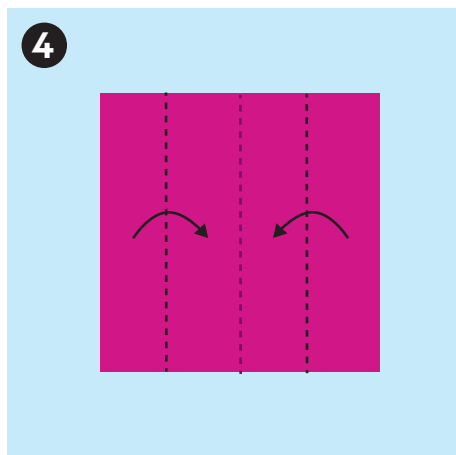

4 Fold the right and left sides into the centre.

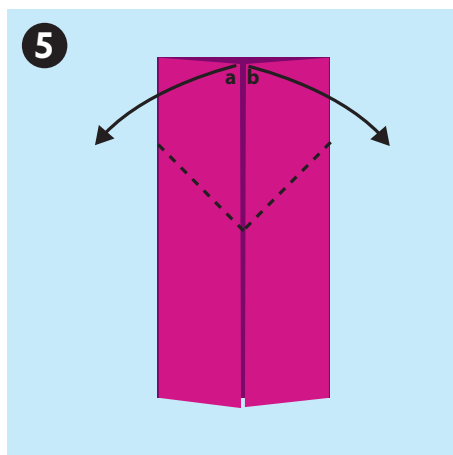

5 Holding the paper down in the centre, pull the central left corner (a) down and out to the side. Do the same with the central right corner (b).

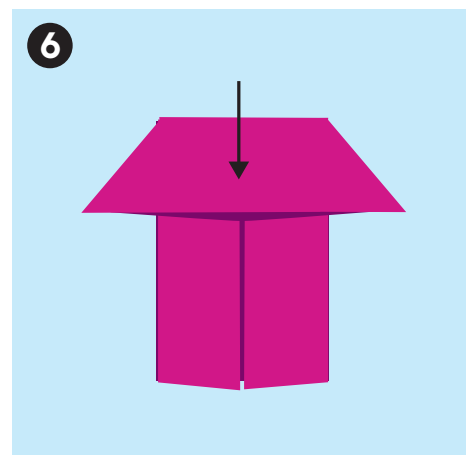

6 Fold down the top and squash down as shown. Repeat steps 5 and 6 on the bottom section.

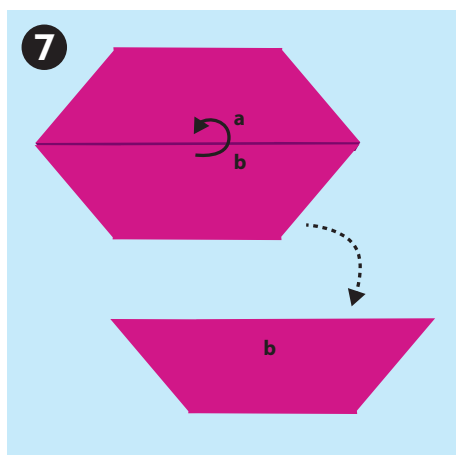

7 Fold the whole model in half, backwards, so the upper half (a) is behind the lower half (b).

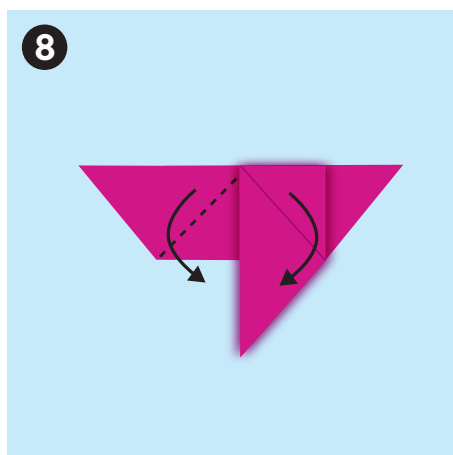

8 Flip the top-right and top-left layers down.

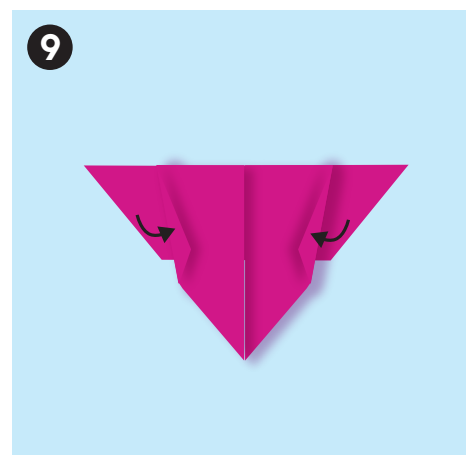

9 On both sides, fold a small section of the top layer in as shown.

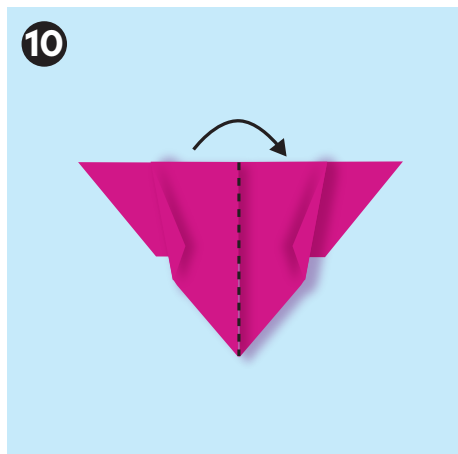

Fold the model in half to the right.

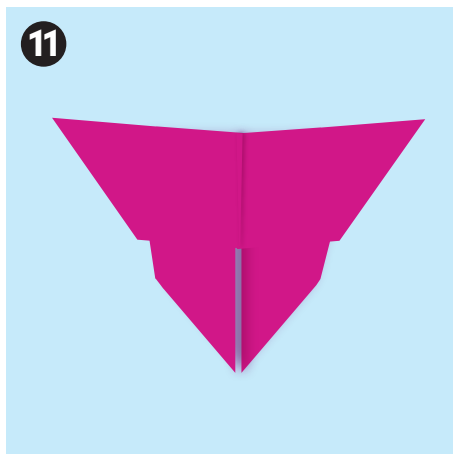

Unfold the model so that the opposite side is facing you, and pinch in the centre section slightly so that it resembles the butterfly's body.

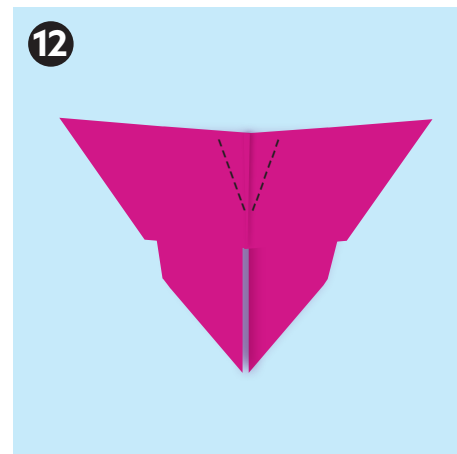

Fold the model in half again and then fold a crease down the widest part of the wings to make your butterfly look more 3D!